

QUICK INSTALLATION

ML

# ALFEA M DUO

Hydraulic unit for Monobloc 2 services

Hydraulic unit

024288



024348



024351

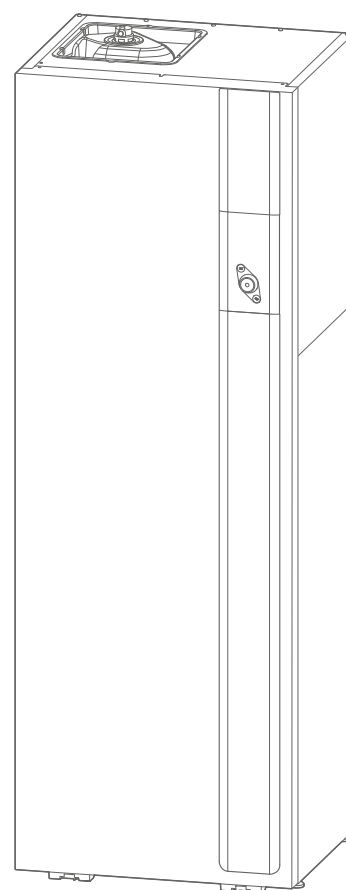
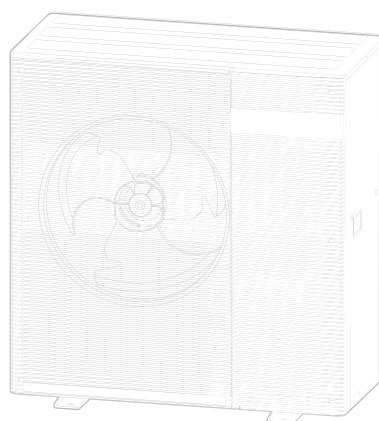

■ ALFEA M DUO

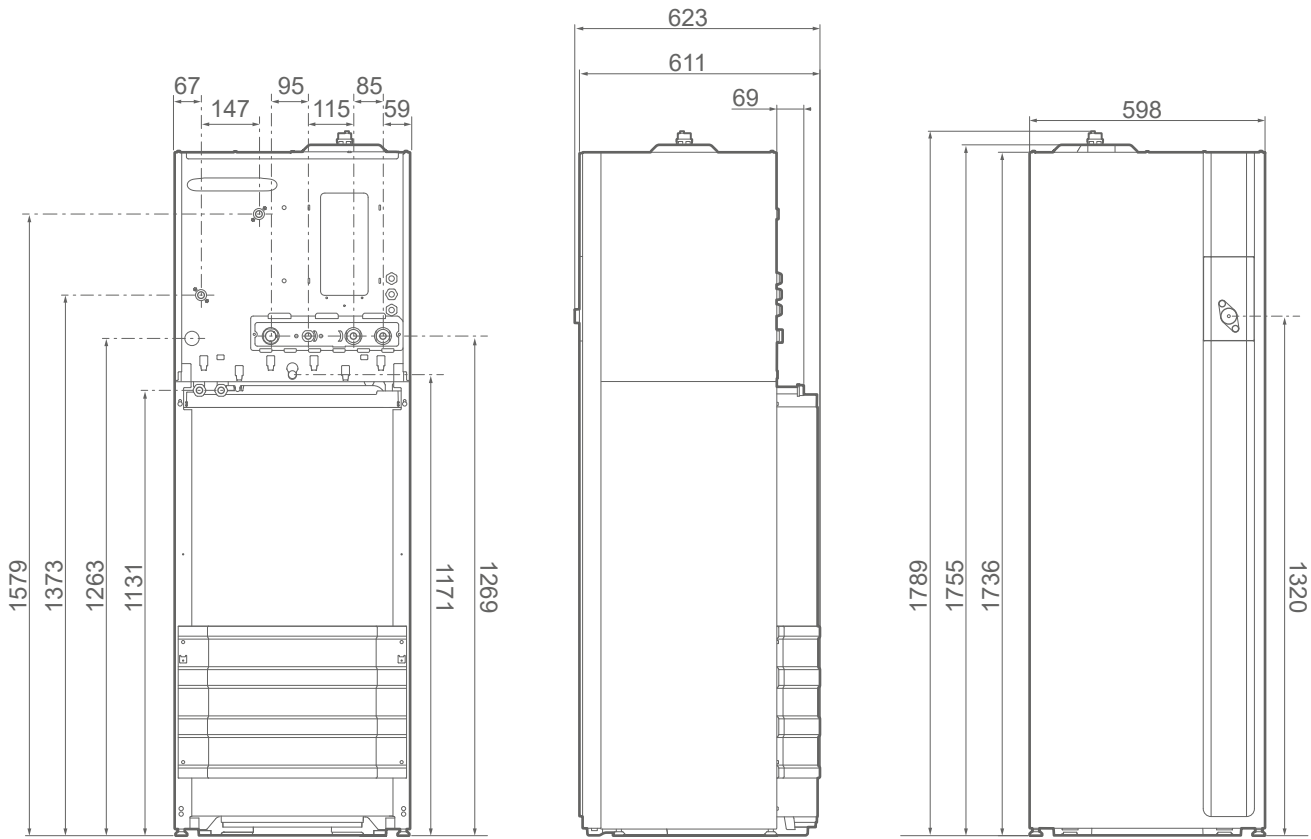

■ ALFEA M DUO

340 kg

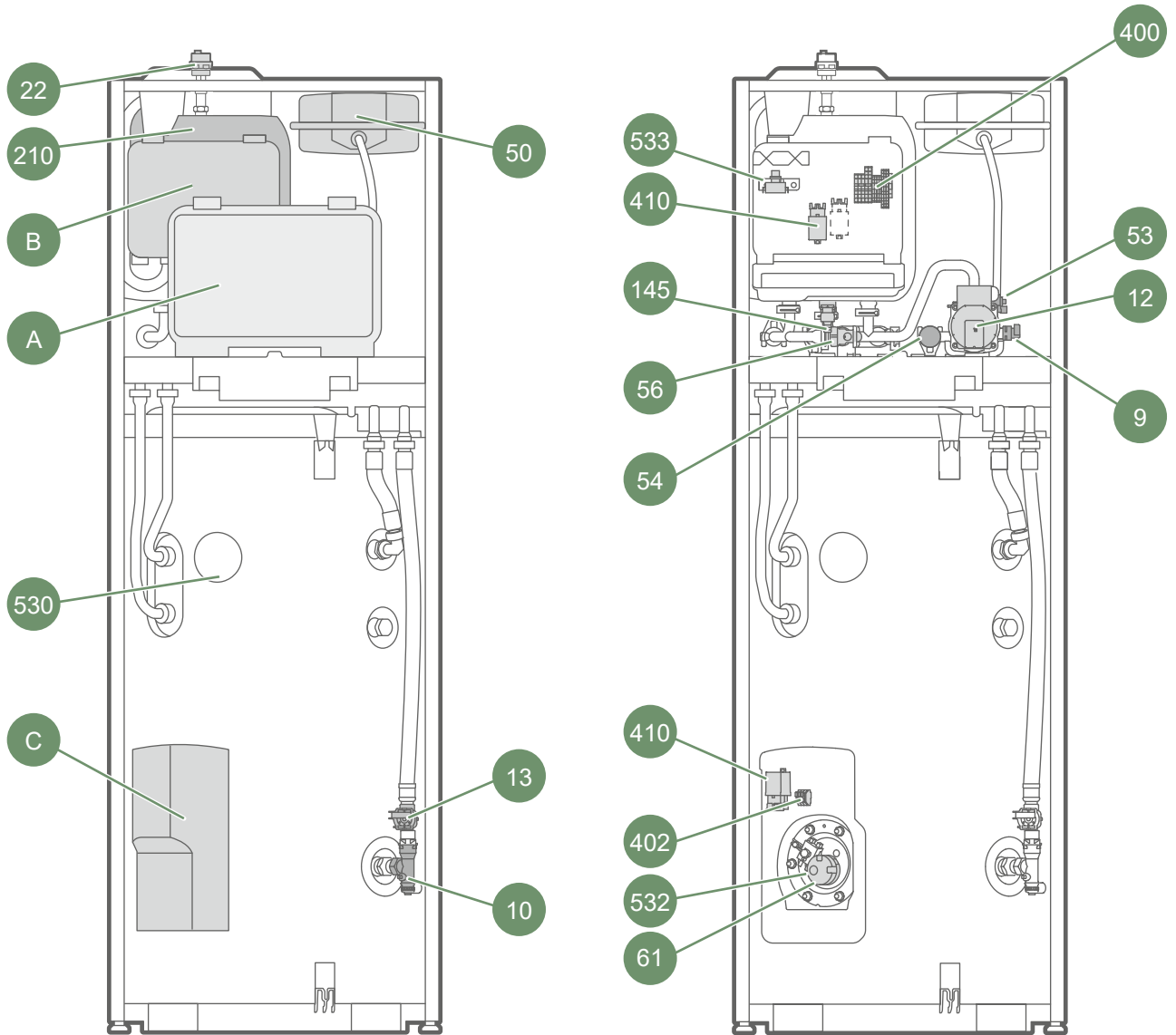
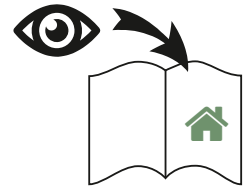

Electric case:

- A - Principal
- B - Electric heating backup
- C - Domestic Hot Water supply

Sensors :

**530** - Domestic Hot Water sensor.

- 9 - Pressure sensor
- 10 - Valve
- 12 - Circulating pump
- 13 - Flowmeter
- 22 - Automatic bleeder valve
- 50 - Expansion vessel
- 53 - Directional valve

- 54 - Manometer
- 56 - Non return valve
- 61 - DHW electrical backup.
- 145 - Drain valve
- 210 - Buffer tank
- 400 - Power supply terminal blocks
- 402 - DHW terminal block

- 410 - Relay
- 532 - DHW safety thermostat
- 533 - Heat pump backup safety thermostat

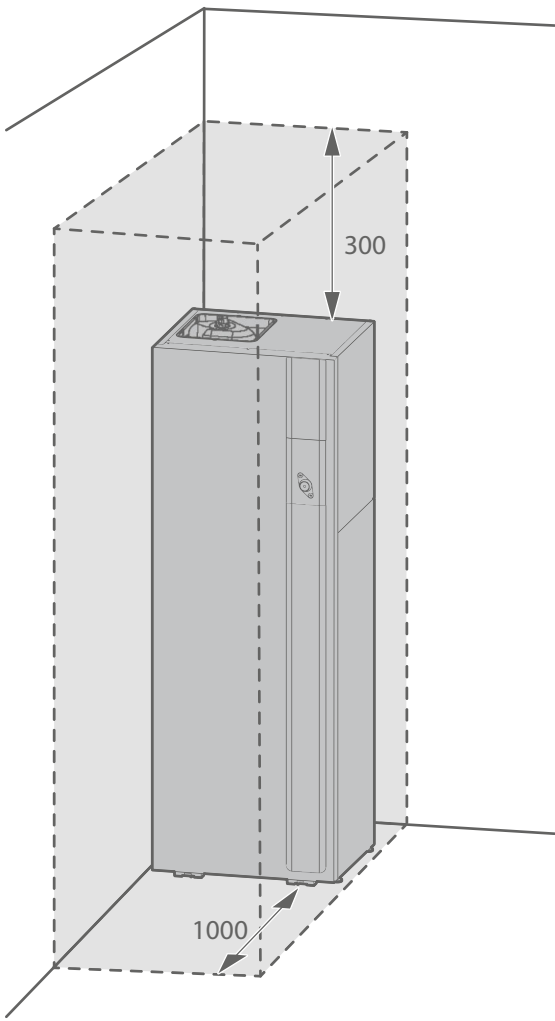
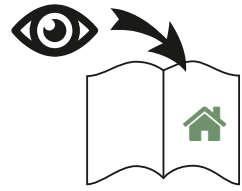

 ■ ALFEA M DUO 340 kg

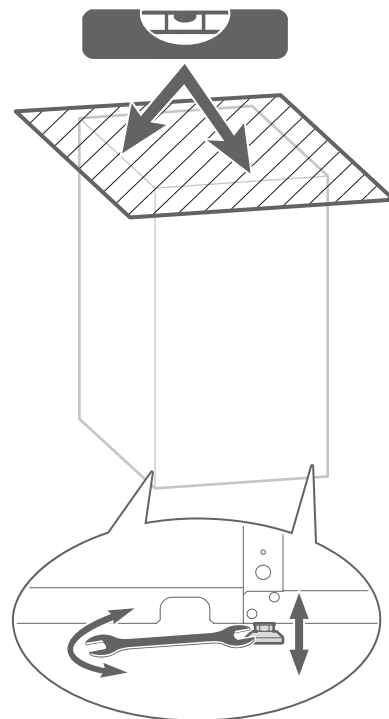
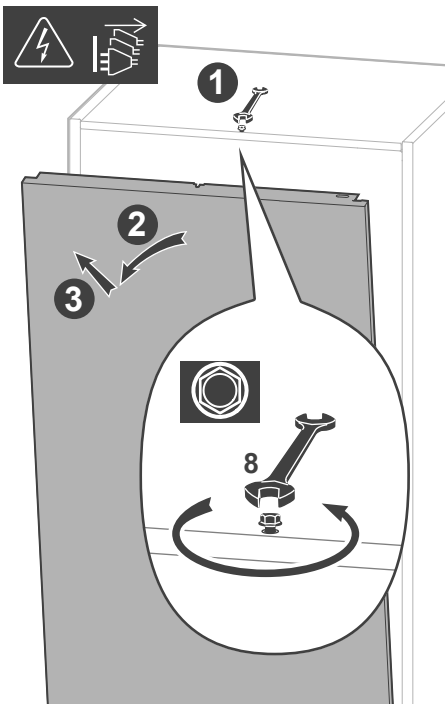

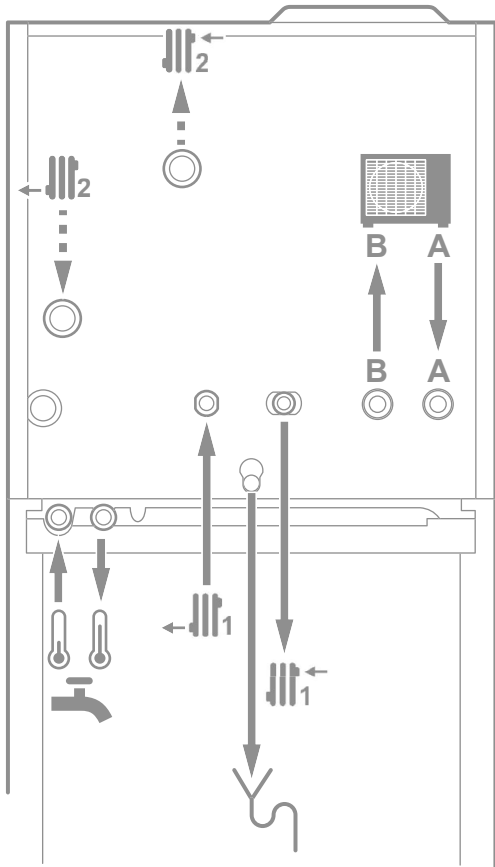
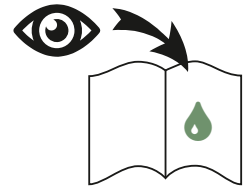

Ø	Tightening torque
1/2"	25 Nm
3/4"	35 Nm
1"	45 Nm
1-1/4"	60 Nm

Installation of OPEN automatic bleeder(s) is prohibited between the outdoor unit and the hydraulic module

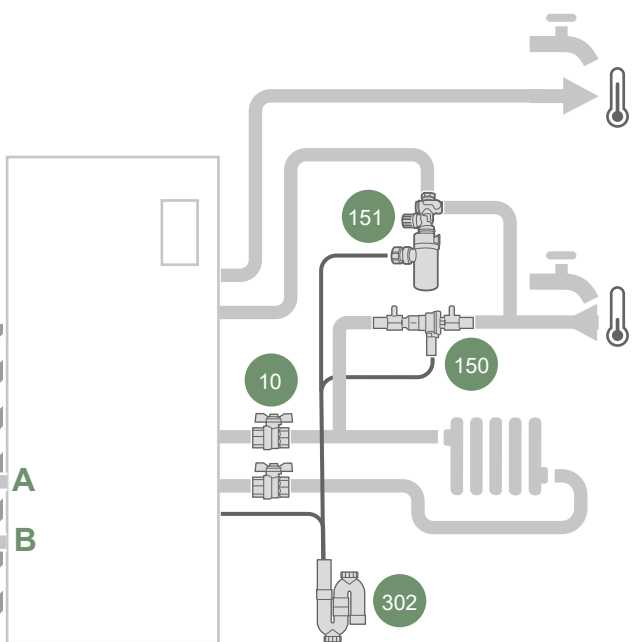
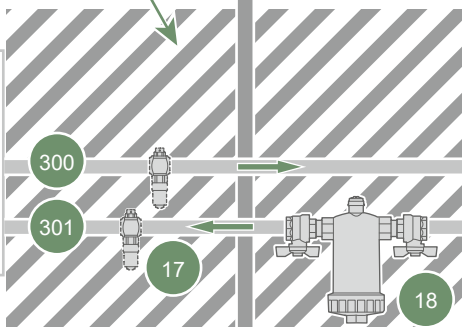
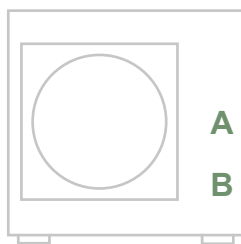

- 10 - Valve
- 17 - Antifreeze valve
- 18 - Sediment trap

- 56 - Non return valve
- 150 - Shut-off
- 151 - Safety valve

- 300 - Outdoor Unit to Indoor Unit Connection
- 301 - Indoor Unit to Outdoor Unit Connection
- 302 - Drain Pipe (Drainage)

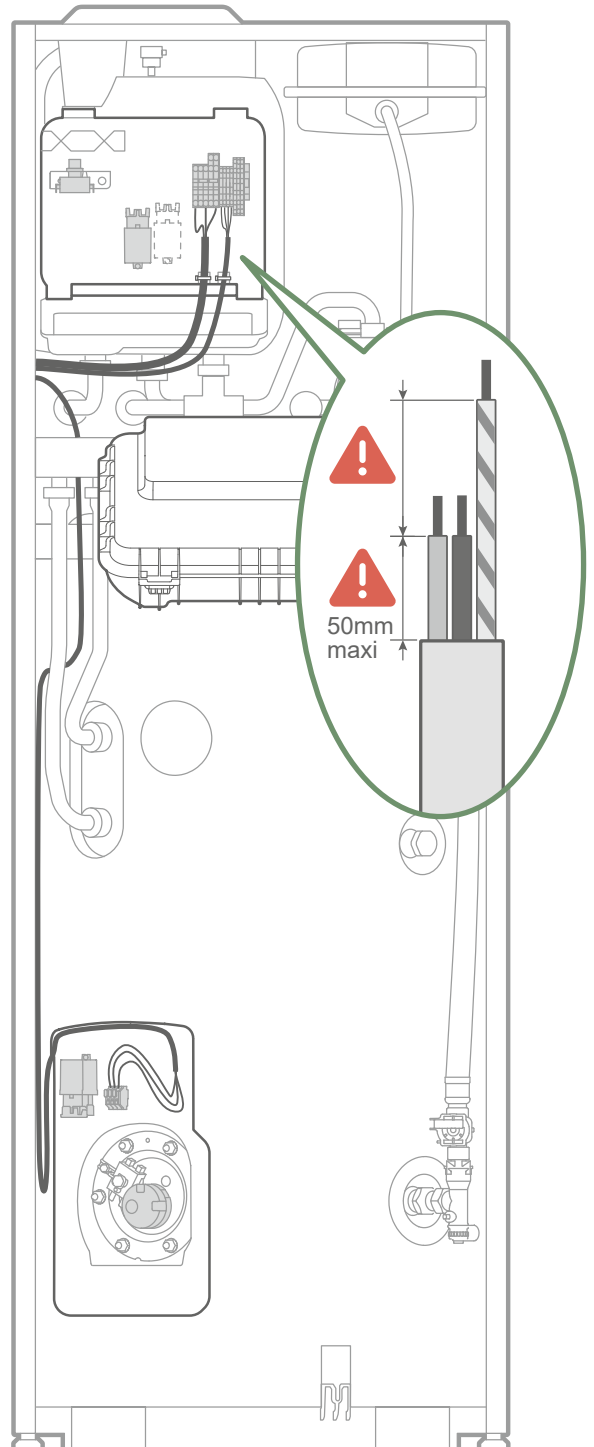
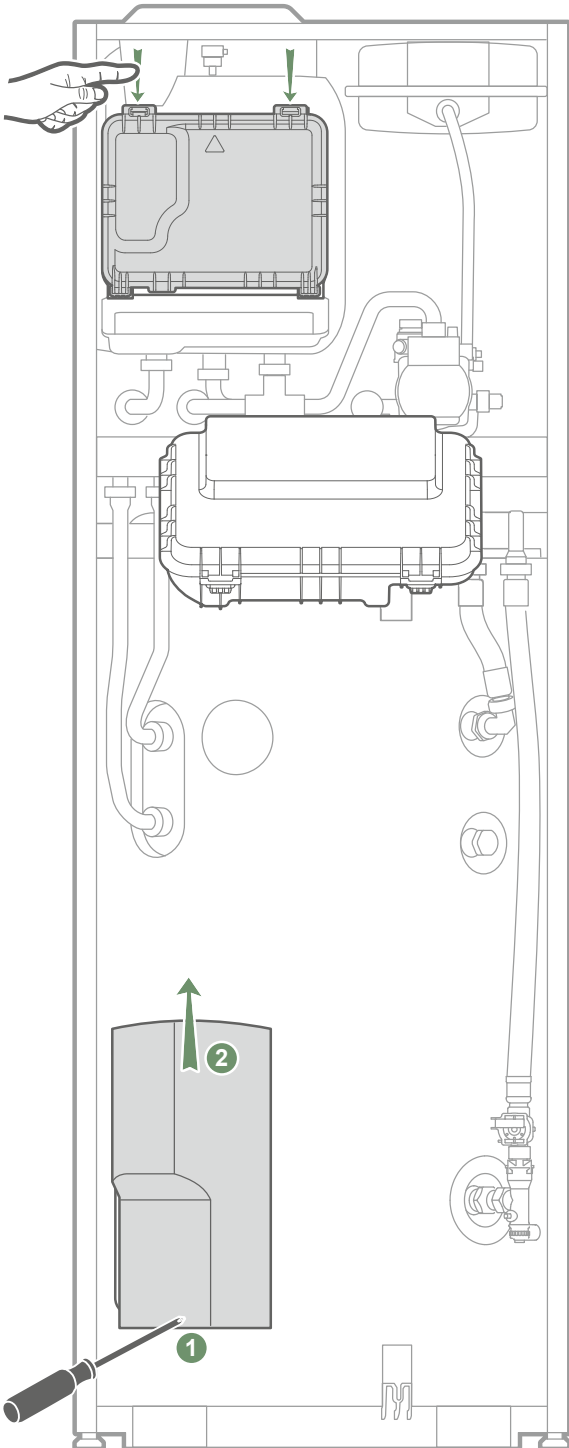
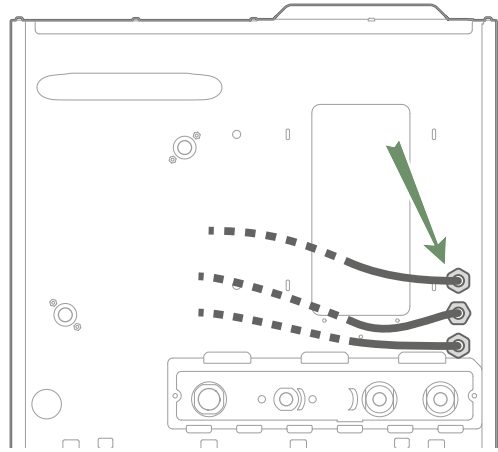
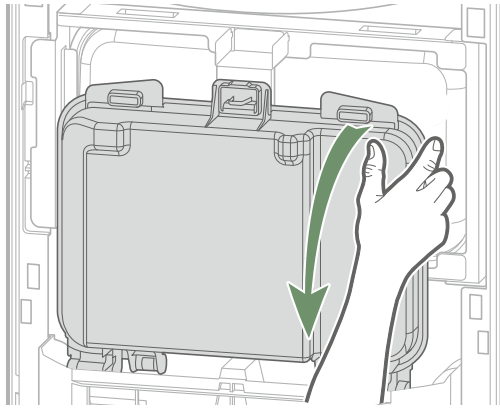

## 230V 1N~

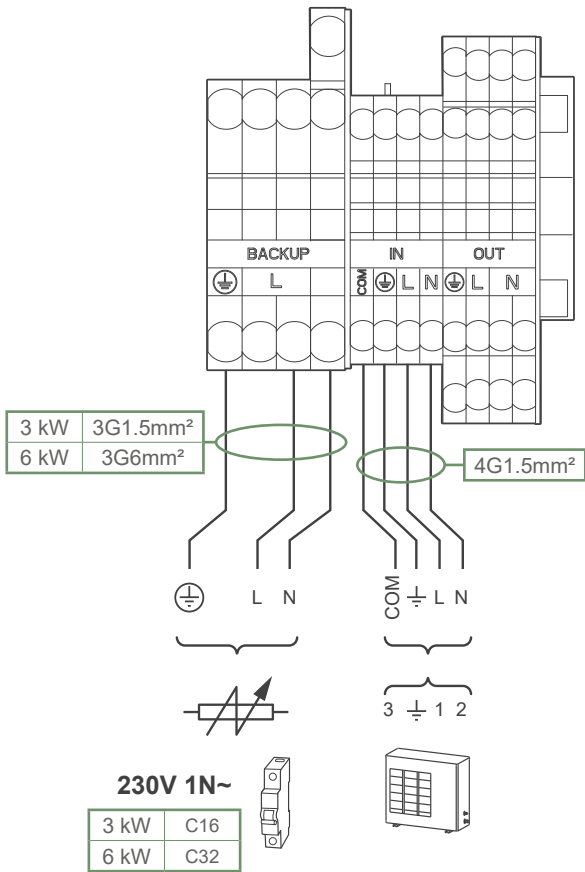
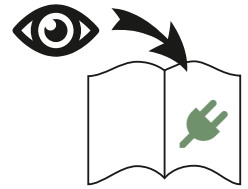

## 400V 3N~

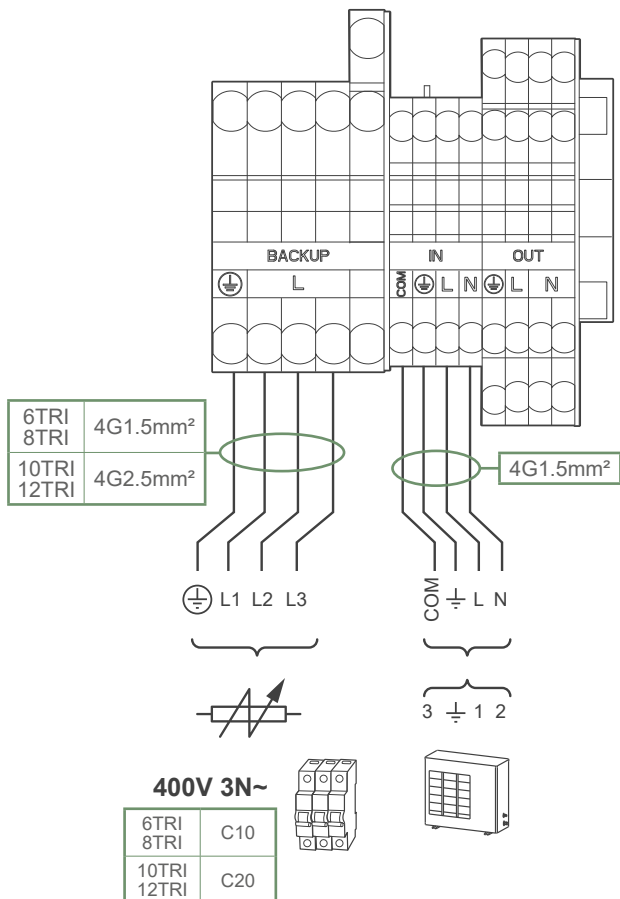

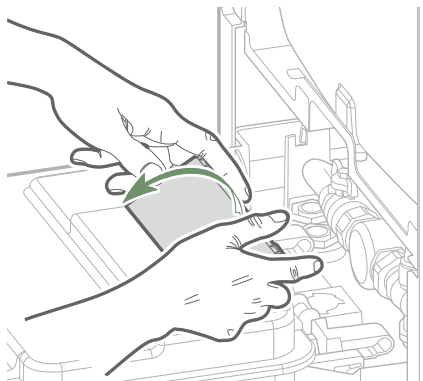
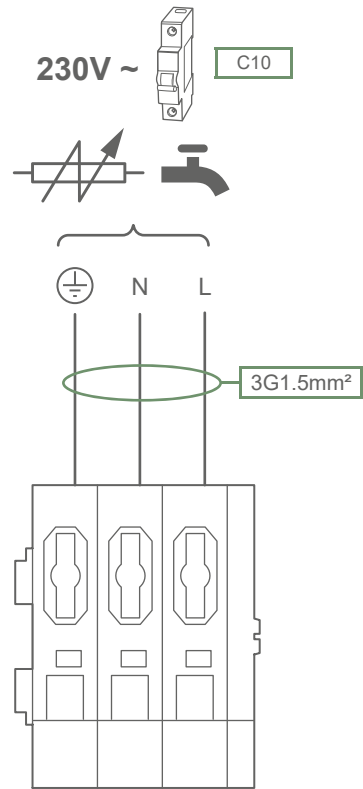



A series of horizontal dotted lines spanning the width of the page, providing a guide for handwriting practice.



A series of 25 horizontal dotted lines spanning the width of the page, providing a guide for handwriting practice.



A series of horizontal dotted lines spanning the width of the page, providing a guide for handwriting practice.

Date of installation : :

Contact of your heating technician or your after-sales service.



This device is compliant with:

- the Radio Equipment Directive 2014/53/EU;
- Directive 2011/65/EU and the applicable delegated directives on the restriction of the use of certain hazardous substances in electrical and electronic equipment;
- the Ecodesign Directive 2009/125/EC and the applicable implementing regulations;

The full text of the EU Declaration of Conformity is available at the following internet address: <https://www.atlantic.fr/>

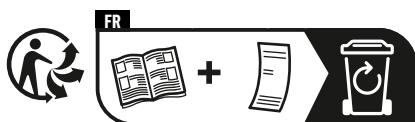

Points de collecte sur [www.quefairedemesdechets.fr](http://www.quefairedemesdechets.fr)